

FRONT VIEW
COMPACTOR
UNIT 1 AND UNIT 2
IN OPEN CONDITION

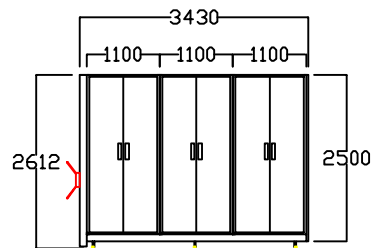

FRONT VIEW
COMPACTOR
LAST UNIT
DFM 21 (UNIT 1)
DFM 13 (UNIT 2)

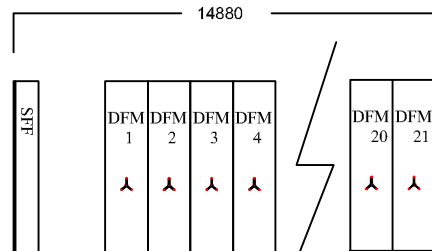

SIDE VIEW
COMPACTOR UNIT 1

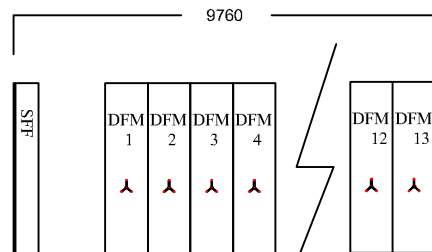

SIDE VIEW
COMPACTOR UNIT 2

COMPACTOR UNIT 1
1) DFM(1,TO 21) DOUBLE FACED
MOVABLE UNIT
SIZE: 3430(L) x 640 (W) x 2580(H) mm
QTY : 21 NOS

3) SFF : SINGLE FACED FIXED UNIT
SIZE: 3430(L) x 350 (W) x 2580(H) mm
QTY : 01 NOS

4) DOOR FOR LAST DFM 21 : SIZE:
1100(L) x 60 (W) x 2400 (H) mm
QTY : 03 NOS

NO OF COMPARTMENTS : 903 NOS
COMPARTMENT APROX SIZE :
1100 X 310 X 315 mm
(L X W X H) in mm

COMPACTOR UNIT 2
1) DFM(1,TO 13) DOUBLE FACED
MOVABLE UNIT
SIZE: 3430(L) x 640 (W) x 2580(H) mm
QTY : 13 NOS

3) SFF : SINGLE FACED FIXED UNIT
SIZE: 3430(L) x 350 (W) x 2580(H) mm
QTY : 01 NOS

4) DOOR FOR LAST DFM 13 : SIZE:
1100(L) x 60 (W) x 2400 (H) mm
QTY : 03 NOS

NO OF COMPARTMENTS :567 NOS
COMPARTMENT APROX SIZE :
1100 X 310 X 315 mm
(L X W X H) in mm

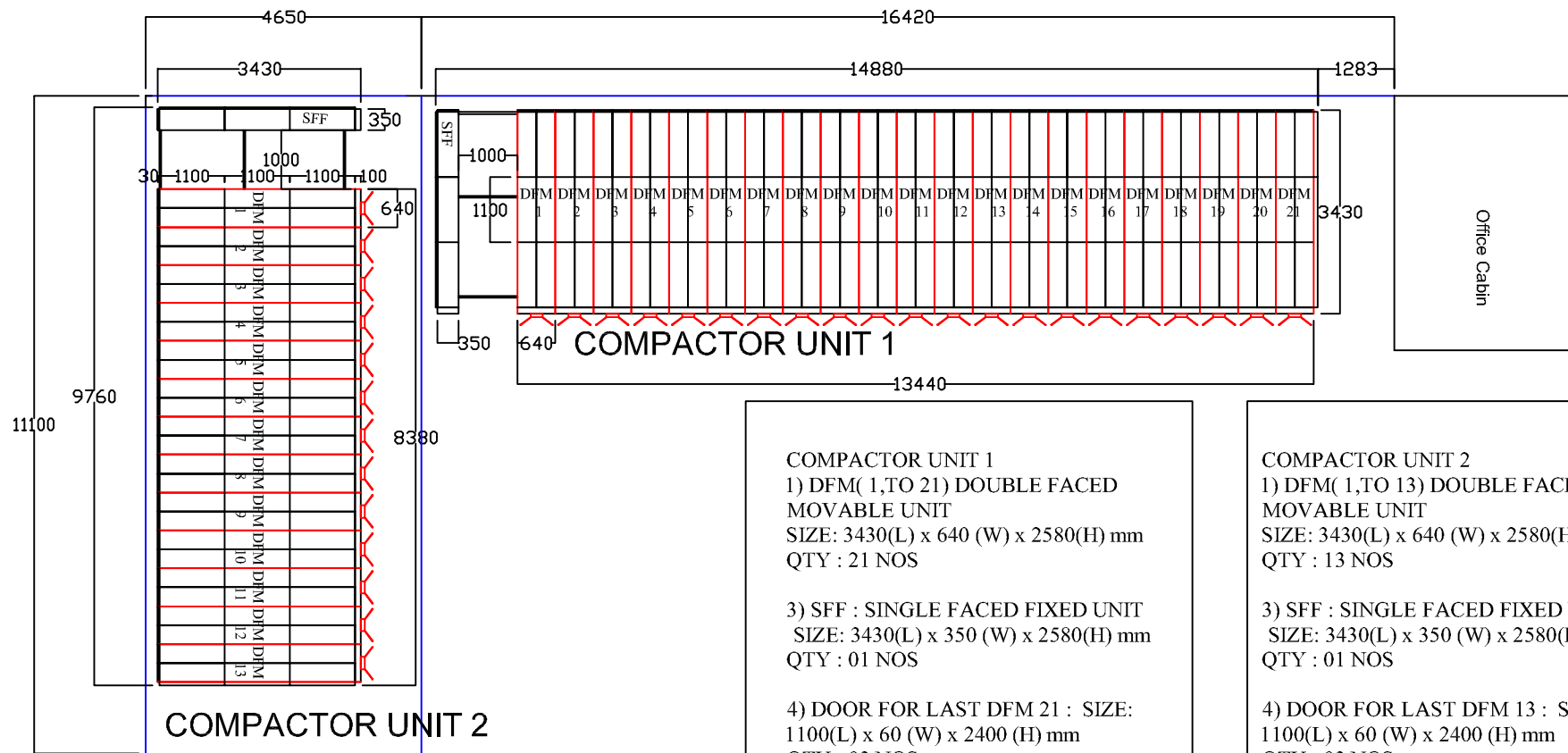

TOP VIEW OF COMPACTORS UNIT 1 AND UNIT 2

COMPACTOR UNIT 1

1) DFM(1,TO 21) DOUBLE FACED
MOVABLE UNIT
SIZE: 3430(L) x 640 (W) x 2580(H) mm
QTY : 21 NOS

3) SFF : SINGLE FACED FIXED UNIT
SIZE: 3430(L) x 350 (W) x 2580(H) mm
QTY : 01 NOS

4) DOOR FOR LAST DFM 21 : SIZE:
1100(L) x 60 (W) x 2400 (H) mm
QTY : 03 NOS

NO OF COMPARTMENTS : 903 NOS
COMPARTMENT APROX SIZE :
1100 X 310 X 315 mm
(L X W X H) in mm

COMPACTOR UNIT 2

1) DFM(1,TO 13) DOUBLE FACED
MOVABLE UNIT
SIZE: 3430(L) x 640 (W) x 2580(H) mm
QTY : 13 NOS

3) SFF : SINGLE FACED FIXED UNIT
SIZE: 3430(L) x 350 (W) x 2580(H) mm
QTY : 01 NOS

4) DOOR FOR LAST DFM 13 : SIZE:
1100(L) x 60 (W) x 2400 (H) mm
QTY : 03 NOS

NO OF COMPARTMENTS :567 NOS
COMPARTMENT APROX SIZE :
1100 X 310 X 315 mm
(L X W X H) in mm

MAX SPACE RACKING SYSTEMS

Gat No 622 At Post Velu Khed Shivapur Tal Bhor Pune Satara Road Dist Pune
Ph 09225608223

E mail: sales@max-spacerackingsystems.com , infomaxspaceracking@gmail.com

Website : www.max-spacerackingsystems.com

Date: 15/07/2025

To

VALLABHDAS VALJI Vachanarya Jalgaon

Sub: Quotation for Manual type Mobile Racking System Compactor Systems

Dear Sir,

With reference to your enquiry for the requirement Compactor Systems .
we are hereby submitting our offer consisting of:-

- 1) Technical Specifications
- 2) Price Summary
- 3) Commercial Terms & Conditions.

If you need any clarifications/doubts please feel free to contact us.

Thanking you and looking forward to receive your valuable purchase order at the earliest

For **MAX SPACE RACKING SYSTEMS**



Mandar Vijay Pitre
Head Operations

TECHNICAL SPECIFICATIONS OF MOBILE STORAGE SYSTEM FOR STORAGE

UNIT 1

DOUBLE FACED MOVABLE UNIT(DFM)New : **21No**

Length	:	3430 mm
Width	:	640 mm
Height	:	2612 mm
Including wheel assy no of Compartments	:	42

SINGLE FACED FIX(SFF) : **01 No**

Length	:	3430 mm
Width	:	350 mm
Height	:	2612 mm
Including wheel assy no of Compartments	:	21

<u>FRONT DOOR</u>	:	03 No
Length	:	1100 mm
Width	:	60 mm
Height	:	2400 mm

CONSTRUCTION

- Shelves made from 0.9 mm CRCA Sheet
- Vertical Covers Made from 0.9 mm Crca Sheet (20 G)
- internal Partitions 0.6 mm will be made from steel confirming to IS 513/63 (Cold Rolled Steel)
Shelves will be bolted to the vertical angles at each of four corners .
- Duly Powder Coated unit with seven tank pre-treatment and Dft of 70 microns. Epoxy Polyester powder

UNDER CARRAIGE STRUCTURE: Six Wheel Base

- Consists of C Chanel (110 x 40) 3.14 mm Thick
- Height of Carriage Including Guide Rail : 180mm
- Guide Wheel Diameter : 130mm
- Diameter of shaft : 25mm
- Guide Rails : 25 sq mm bar (EN 8)
- Step type Wheel for easy movement of racks back and front Panels in CRCA Sheet20G
- Rails will be covered from both sides for safety of feet of operator

SAFETY PROVISION:

- Central Locking Devise: Facilitates the locking of the entire system. Inbuilt in last mobile unit.
- End stoppers provided at the ends of rails prevents derailment of the carriage while in operation
- Anti-tilt arrangement will be provided
- d) Safety locking arrangement on each handle assembly. 5/8 Simplex Chain and Sprocket mechanism with Safety Locking Mechanism for Easier Handling Of The System .**
- Totally powder coated unit except for base Frame (Under Carriage Structure)
- When installed four sides of installation will be fully covered.
- MAX Load /compartment :70 kgs UDL/COMPARTMENT

UNIT 2

DOUBLE FACED MOVABLE UNIT(DFM)New : **13 No**

Length	:	3430 mm
Width	:	640 mm
Height	:	2612 mm
Including wheel assy no of Compartments	:	42

SINGLE FACED FIX(SFF) : **01 No**

Length	:	3430 mm
Width	:	350 mm
Height	:	2612 mm
Including wheel assy no of Compartments	:	21

<u>FRONT DOOR</u>	:	03 No
Length	:	1100 mm
Width	:	60 mm
Height	:	2400 mm

CONSTRUCTION

- e) Shelves made from 0.9 mm CRCA Sheet
- f) Vertical Covers Made from 0.9 mm Crca Sheet (20 G)
- g) internal Partitions 0.6 mm will be made from steel confirming to IS 513/63 (Cold Rolled Steel)
Shelves will be bolted to the vertical angles at each of four corners .
- h) Duly Powder Coated unit with seven tank pre-treatment and Dft of 70 microns. Epoxy Polyester powder

UNDER CARRIAGE STRUCTURE: Six Wheel Base

- h) Consists of C Chanel (110 x 40) 3.14 mm Thick
- i) Height of Carriage Including Guide Rail : 180mm
- j) Guide Wheel Diameter : 130mm
- k) Diameter of shaft : 25mm
- l) Guide Rails : 25 sq mm bar (EN 8)
- m) Step type Wheel for easy movement of racks back and front Panels in CRCA Sheet20G
- n) Rails will be covered from both sides for safety of feet of operator

SAFETY PROVISION:

- h) Central Locking Devise: Facilitates the locking of the entire system. Inbuilt in last mobile unit.
- i) End stoppers provided at the ends of rails prevents derailment of the carriage while in operation
- j) Anti-tilt arrangement will be provided
- k) Safety locking arrangement on each handle assembly. 5/8 Simplex Chain and Sprocket mechanism with Safety Locking Mechanism for Easier Handling Of The System .**
- l) Totally powder coated unit except for base Frame (Under Carriage Structure)
- m) When installed four sides of installation will be fully covered.
- n) MAX Load /compartment :70 kgs UDL/COMPARTMENT

PRICE SUMMARY

TYPE – A Mobile Compactor Storage

Unit 1

S No	Item Description	Qty	Unit Rate (Rs.)	No. of Units	Amount (Rs.)
1	Double Faced Movable Unit(DFM) New	01	89765	21	1885065.00
2	Single Faced Fix Unit(SFF)	01	46495	01	46495.00
3	Fron Door	01	6950	03	20850.00
4	Total Basic Material Cost				1952410.00
4	Transport	01		01	36700.00
4	Installation	01	73650	01	73650.00
Total : TWENTY LAKH SIXTY TWO THOUSAND SEVEN HUNDRED SIXTY ONLY.					Rs 2062760.00

TYPE – A Mobile Compactor Storage

Unit 2

S No	Item Description	Qty	Unit Rate (Rs.)	No. of Units	Amount (Rs.)
1	Double Faced Movable Unit(DFM) New	01	89765	13	1166945.00
2	Single Faced Fix Unit(SFF)	01	46495	01	46495.00
3	Fron Door	01	6950	03	20850.00
4	Total Basic Material Cost				1234290.00
4	Transport	01		01	18000.00
4	Installation	01	31950	01	31950.00
Total : TWELVE LAKH EIGHTY FOUR THOUSAND TWO HUNDRED FOURTY ONLY					Rs 1284240.00
Total Cost of Unit 1 + Unit 2					Rs 3347000.00
Discount :					Rs 144950.00
Final Offer Price :					Rs 3202050.00
In Words : Rs Thirty Two Lakh Two Thousand Fifty only .					
18 % GST Extra					

COMMERCIAL TERMS & CONDITIONS

- a) The offered prices are including transport .
- b) GST @ 18 % for Material and GST @ 18% for installation extra
- c) Payment terms – 60% Advance along with Purchase order balance 30% of the Dispatched qty with taxes will be against proforma invoice before each dispatch. Remaining 10 % on completion .
- d) Payment terms for Installation & commissioning 50% advance and balance 50% with taxes immediately against completion of work.
- e) Delivery 120 days from the date of receipt of technically & commercially cleared purchased order with advance payment. ten days for installation extra. PHASE WISE DELIVERY AND COMPLETION
- f) Warrantee 24 months from the date of dispatch or 22 months from the date commissioning whichever is earlier. THIS STANDS VOID FOR DAMAGES DUE TO IMPROPER HANDLING/LOADING OR FOR ANY MODIFICATION CARRIED OUT BY CUSTOMER WITHOUT INTIMATING US
- g) Validity – our offer is valid for 15 days from the date of quotation.

For **MAX SPACE RACKING SYSTEMS**



Mandar Vijay Pitre
Head Operations